



Eclarity Mini

OTC Hearing Aids

Manual

www.edifier.com



Product description and accessories

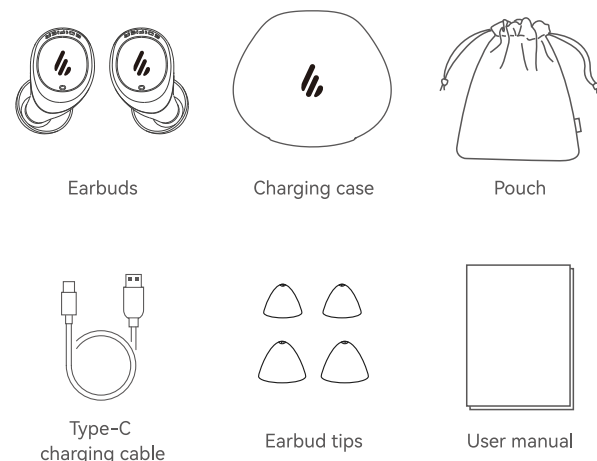

Note

Hearing aid mode is designed to improve user's voice recognition and supplement their hearing capabilities. Personnel with normal hearing conditions should refrain from using this mode.

- This product is not a replacement for medical hearing aids; Not recommended to use for minors.
- There are different sizes of earbud tips included. Please choose the right fit.
- Images are for illustrative purposes only and may differ from the actual product.

1

Operational guide

Power ON/OFF

- Power on when the case is opened.
- Power off when placed in the case and the case is closed.

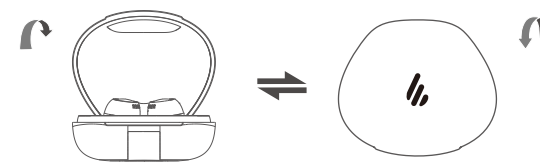

Charge the earbuds

- Place the earbuds in the case and close the case for charging.

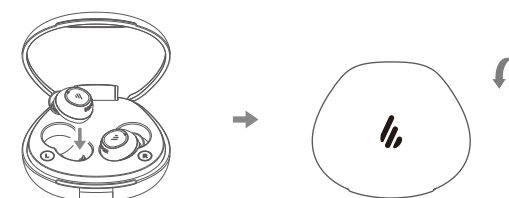

Note

Please ensure the charging case is charged before charging the earbuds.

2

Operational guide

Charge the charging case

Connect the charging case to a power source via the included Type-C charging cable.
Green LED on = charging
Indicator light off = fully charged

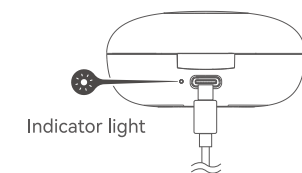

Input: 5V = 200mA (earbuds)
5V = 1A (charging case)

Battery level

- Open/close the charging case to show its battery level;
 - Or press the button on the case to show its battery level when the case is opened.
- Indicator light when showing:
White LED = high battery
Green LED = medium battery
Green LED rapidly blinking = low battery

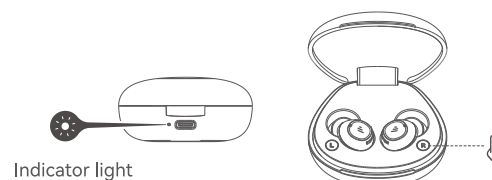

3

Pairing

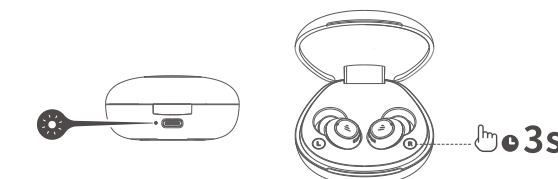

Initial use

- Open the lid of the charging case and keep earbuds inside; the indicator light will blink white and green, and the device will enter Bluetooth pairing mode.
- Select "EDIFIER Eclarity Mini" in your phone settings to connect.
- Once completed, the earbuds will auto-connect to this smartphone device whenever the device's Bluetooth is turned on.

Connect to a new smartphone device

- Open the lid of the charging case and keep earbuds inside.
- Press and hold the button on the case for about 3s. The indicator light will blink white and green, and the device will enter Bluetooth pairing mode.
- Select "EDIFIER Eclarity Mini" under Bluetooth devices in new smartphone device's settings.

Note

- When smartphone device's Bluetooth is turned on, the earbuds can auto-connect to the device, given that it has been paired before;
- If the afore mentioned device's Bluetooth feature is ever turned off, you'll need to manually select the earbuds under Bluetooth devices in your smartphone device's settings.

4

For more information, please visit our website:

www.edifier.com



@Edifierglobal



@Edifier_Global



@Edifier_Global

Model: EDF800013
Edifier International Limited
P.O. Box 6264
General Post Office
Hong Kong

www.edifier.com
©2024 Edifier International Limited. All rights reserved.
Printed in China

NOTICE:
For the need of technical improvement and system upgrade, information contained herein may be subject to change from time to time without prior notice.

Products of EDIFIER will be customized for different applications. Pictures and illustrations shown on this manual may be slightly different from actual product. If any difference is found, the actual product prevails.

IB-200-ECMINI-00 V1.0

Left and right earbud synchronize/reset

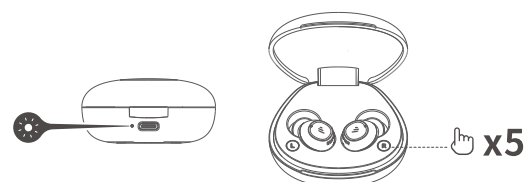

- The left/right synchronization has been completed at default. If necessary, you can follow the steps below to resume the left/right synchronization.
- Open the lid of the charging case and keep earbuds inside.
- Press the button on the case 5 times; the indicator light will blink white, and the device has entered left/right synchronization mode.
- The earbuds will auto-enter Bluetooth pairing mode if successful; the indicator light will blink white and green.

Functional operations

Hearing aid mode

- Accept a call: Tap either earbud
- Play: Double tap either earbud
- Volume control: Tap either earbud
- Switch scene mode: Tap and hold either earbud



Tap area

Music mode

- Accept a call: Tap either earbud
- Pause: Double tap either earbud
- Volume control: Tap either earbud

Download EDIFIER Assist app for more customizable control settings.

Note

- Tapping either earbud can only accept phone calls; any calls via third party apps are not supported.
- For iOS devices, if the call is accepted using the answer button on the phone, the audio will then be played via the phone speaker and not the earbuds.

5

Specifications

Equivalent input noise level: ≤23dB
Harmonic distortion: ≤3%
Maximum Output Sound Pressure Level (OSPL₉₀): 116dB SPL
High frequency average OSPL₉₀ (HFA-OSPL₉₀): 113dB SPL
Full on Gain (FOG): 30dB
Frequency response (Hearing Aid mode): F1≤200Hz F2≥6kHz
Frequency response (Bluetooth mode): 20Hz-20kHz
Charging time: around 2 hours
Input: 5V = 200mA (earbuds) 5V = 1A (charging case)
Battery life: Hearing Aid mode: around 13Hr per charge/
84Hr in total (earbuds)
Bluetooth mode: around 4Hr per charge/
24Hr in total (earbuds)

6

FAQs

The indicator light is off during charging.

- Please ensure the charging case is correctly connected to a power source.

No audio

- Check if the earbuds are turned on.
- Increase the earbuds' volume.

FCC statement:

This device complies with Part 15 of the FCC Rules. Operation is subject to the following two conditions:
(1) this device may not cause harmful interference, and (2) this device must accept any interference received, including interference that may cause undesired operation.
IC statement: CAN ICES-003(B) / NMB-003(B).

FCC ID: Z9G-EDF238

7

Important safety information

Please read the safety instructions below carefully and use the product in accordance with them, so as to achieve the optimum performance of the product and also to avoid dangers or non-compliance.

Electronic devices

- To avoid interfering with other electronic devices or causing any dangers, do not use the product in places where wireless devices are expressly disallowed.

Effects on other medical devices

- Please abide by regulations therein and turn the product off in places for medical treatment or health care, where wireless devices are expressly disallowed.
- Radio waves generated by the product may affect the normal use of implantable medical devices or personal medical devices (e.g., pacemakers, cochlear implants, etc.). If you use these devices, please consult their manufacturers about restrictions on using the product.
- There are magnetic materials contained in the product, please consult your doctor about whether they will affect implantable medical devices.
- Do not use the product in the vicinity (closer than 15cm) of the implanted medical devices (e.g., pacemakers, cochlear implants, etc.).

Road safety

- Drive safely and never engage in activities that will distract you from while driving.
- There may be radio interferences between electronic devices in vehicles and this product. Please contact the manufacturer for details.
- Wireless devices may interfere with the flight system of aircrafts. Please abide by relevant regulations of airlines and stop using the product in places where wireless devices are expressly disallowed.

Surroundings

- Do not use the product in places with dust, high humidity, and smudges or near magnetic fields to avoid affecting the internal circuits.
- Keep the product away from electric appliances with strong magnetic or electric fields (e.g., microwave ovens, refrigerators, etc.).
- For user safety and product protection, do not use the product during lightning storms.

8

Important safety information

- Using the product in a 0°C~+45°C environment is recommended. Battery performances will be hindered when the temperature is lower than +5°C.
- Do not place the product in places exposed to direct sunlight, such as on a car dashboard or beside a window.
- Do not place the product near any heat source or open fire (e.g., heaters, microwave ovens, ovens, water heaters, stoves, candles, etc.), or any other places that may generate heat.
- Do not place sharp metal objects (e.g., pins etc.) near the product's receiver or speaker to prevent metal objects from adhering to and causing injury to you.

Accessories

- Use only accessories approved by the manufacturer and attached in the package. Otherwise, it may violate warranty terms and relevant regulations of the country where the product is located, even lead to safety accidents. Please contact the manufacturer for the approved accessories.

- The power source used must be approved by relative departments and in accordance with electrical specifications of devices as well as local regulatory requirements (e.g., UL, CSA, VDE, CCC), otherwise there may be dangers of fire, explosion, etc.

Batteries

- Do not dismantle or modify batteries, insert foreign objects into batteries, or immerse batteries into water or other liquids to avoid battery leakage, overheating, fire or explosion. Batteries should only be replaced by manufacturers.
- Do not throw, squeeze or puncture batteries. High external pressure may cause batteries to short-circuit and/or overheat.
- Do not use batteries after being immersed in water. Batteries subjected to extremely low air pressure may result in an explosion or leakage etc. If the battery looks swollen, leaking, discolored, having odor or any abnormal appearance, stop using it. Immediately dispose of batteries carefully in accordance with local laws and regulations regarding battery disposal.

Maintenance

- Lithium-ion batteries require to be charged at least once in every three months.
- To reduce the risk of fire and electric shock, do not expose the product and its accessories to rain or moisture.

9

Important safety information

- Before cleaning and maintaining the product, please cease to use it and disable all applications, and disconnect from other devices or unplug all connecting cables.
- Never use strong chemicals, cleaners or detergents to clean the product or its accessories. Use only clean and dry cloth to wipe the product or its accessories.
- Do not keep magnetic stripe cards (e.g., bank cards, telephone cards, etc.) in contact with the product for a long time, otherwise the magnetic stripe card may be damaged by the magnetic field.
- To avoid product malfunction, fire and/or explosion, do not place the product and its accessories in areas with excessively high or low temperature.

Cautions

- This product is not applicable to people having acute otitis externa, myringitis, chronic suppurative otitis media (in the period of purulent infection), acute suppurative otitis media, and those who are allergic to the product materials.
- Please immediately cease to use the product if you feel discomfort in ears while using.
- Keep product away from children under the age of 14.
- Please make sure product is inaccessible to young children and pets, to avoid them from swallowing parts of the product.
- Immediately seek professional medical assistance if the lithium battery built-in the product is accidentally swallowed.
- To reduce the risk of fire and personal injury, do not open or remove the product housing for repair.
- In case of any product damages, it must be repaired by professionals or contact the manufacturer.
- Never throw batteries into fire or places of high temperature, the battery will explode in over 100°C environments.

Environmental protection

- Do not dispose of the product and its accessories as normal household waste.
- Please abide by local regulations on the disposal of the product and its accessories.

10