

**GC430XXXX**

User Guide

## Supplied items in packaging:

1. Navigation device
2. Cradle
3. Car mount
4. Pre-installed SD memory card
5. Support CD
6. CD with navigation software
7. Car adaptor
8. Instruction manual and warranty card

## Function keys and I/O interfaces:

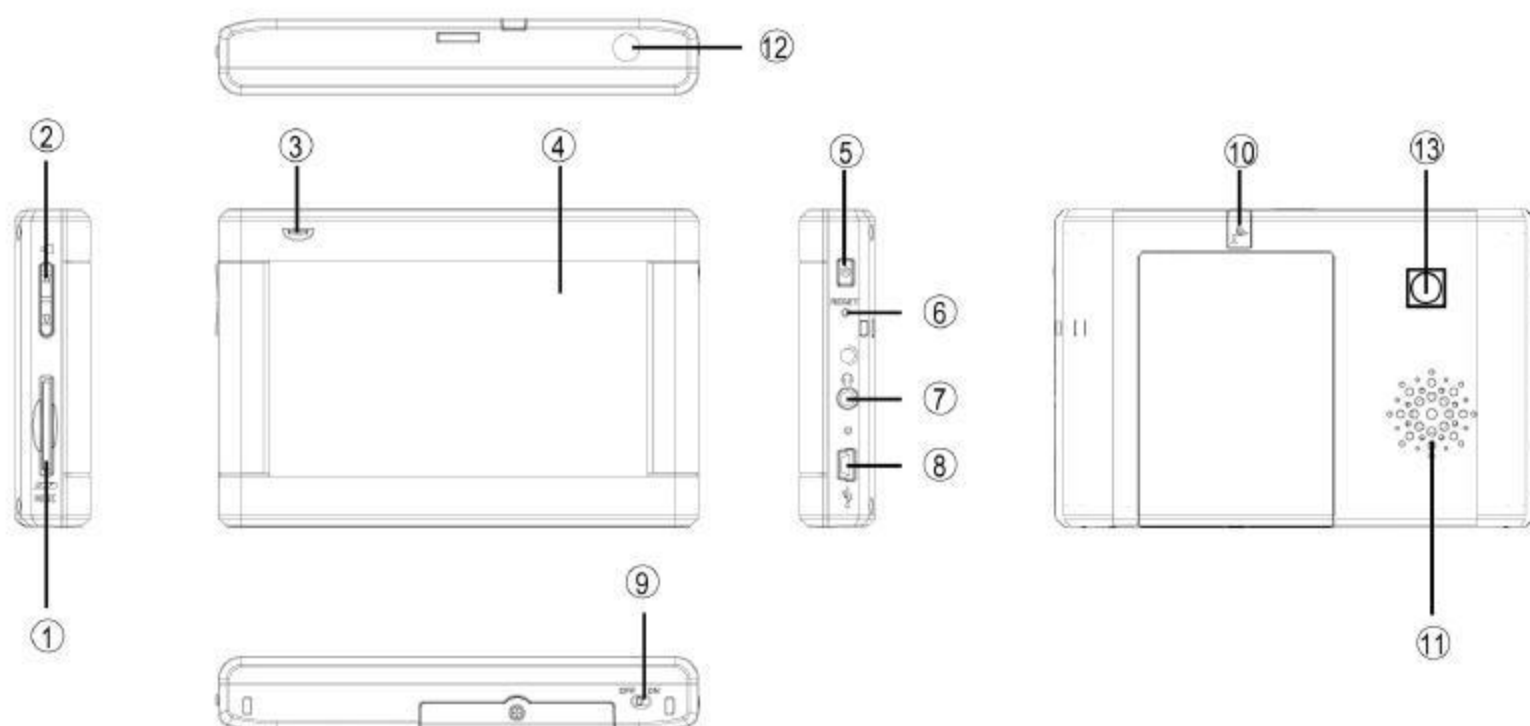

Ref Component	Description
1. SD/MMC Slot	Accepts an optional SD (Secure Digital) or MMC (MultiMedia Card) card for removable storage.
2. Volume key	Turns the volume up/down.
3. Battery Charge Indicator	The loading display will shine red during the charging process. It will shine green when the accumulator is completely charged.
4. Touch Screen	Displays the output of your appliance. Tap on the screen with your finger, a stylus or a "blunt" tipped pen to select menu commands or enter data.
5. Power S/W	<b>Power on/off</b>
6. On/Off Button	Turns the device on or off.
7. Rest button	<b>Restarts your appliance.(Rest).</b>
8. Headphone Connector	<b>Connectsto Stereo headphones.</b>
9. Mini-USB-Connector	<b>Connection for connecting to a pc by means of the USB cable(for data maeching)</b>
10. External antenna connection	<b>Connection for an opeional external GPS antennal</b>
11. Loudspeaker	<b>Plays back music, language statements and warnings</b>
12. Shutter	<b>Press the button to take photos.</b>
13. Cameras lens	<b>Im pixels camera lems.</b>

# Initial Set up:

## 1.Switching on the navigation system

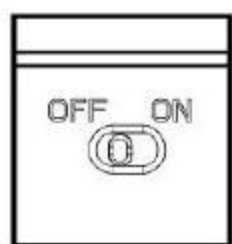

Remove the protective plastic from the screen and ensure the main power switch on the right side of the unit is in the ON position.

**!** Attention: Always leave the main switch in the ON position. The switch should only be set in the OFF position to preserve battery charge if the unit is to be stored for an extended period of time.

## 2.Charging the battery Car

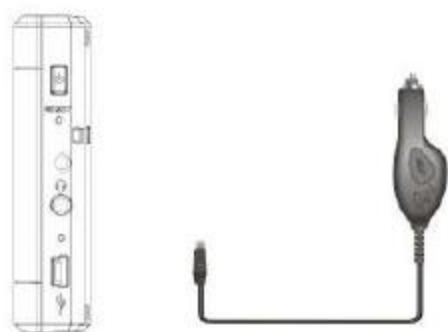

**!** Attention: It is necessary to charge the battery **before** initially power on the device. Please switch on the device when charging.

The charging indicator is red until the navigation system is fully charged. When the navigation device is fully charged the charge indicator turns green.

Note: You can use the navigation system during the charging process.

## 3.Attaching the cradle to car mount

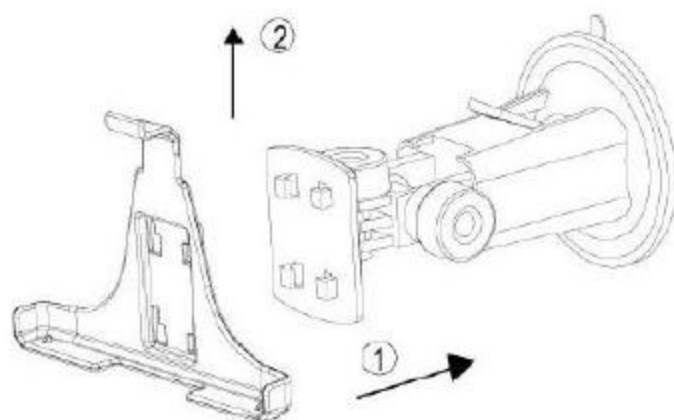

## 4. Mounting the car holder to windshield or on dashboard

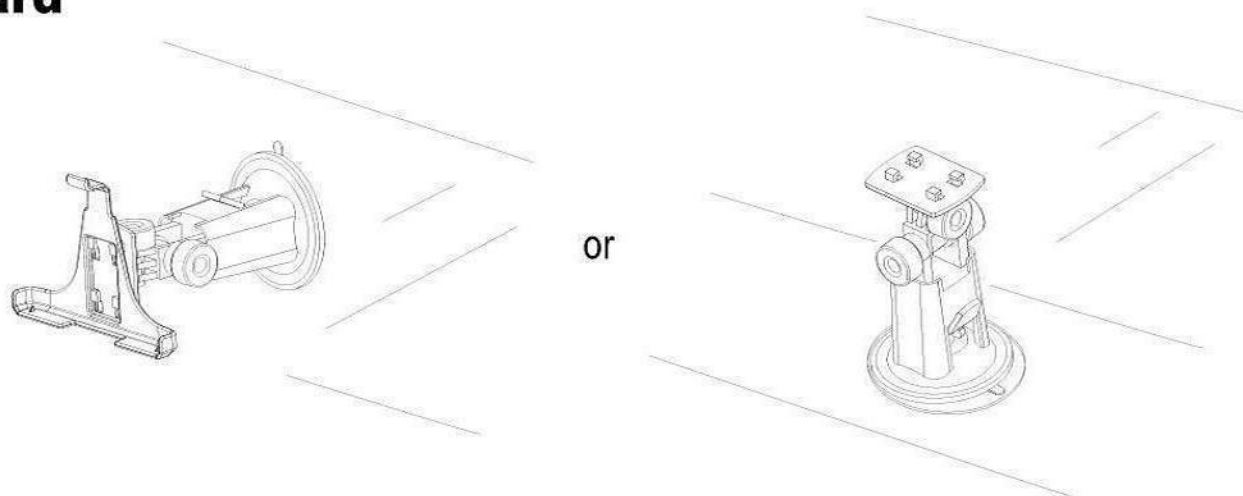

⚠ Attention: Only fix the holder for the navigation device to the windshield/dashboard in a position that does not impede driver's view of the road.

## 5. Attaching navigation device

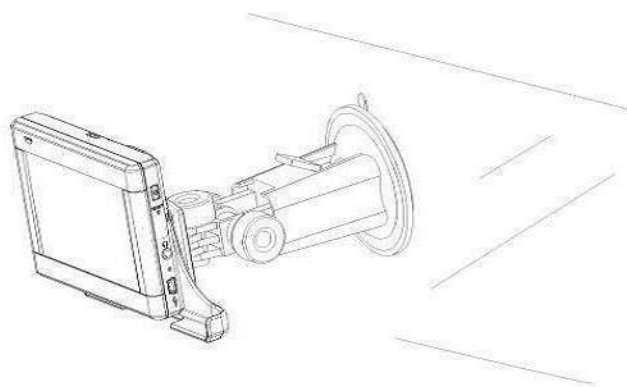

## 6. Power ON/OFF the device

Press the power button  to turn the unit on. The unit will display the main screen. Tap the "Navigation" button on the screen to start the navigation system.

### ※Bluetooth FEATURES :

Suitable for GPS, .....

Small size and Low Profile using high-density packaging technology for space critical applications.

High sensitivity for better reception

Various interfaces : USB.

Wide operating temperature range : -40~+85°C.

Bluetooth Specification : Version 2.0, No EDR function.

Frequency : 2402~2480MHz

※ This product should avoid static electricity interference, if the product suffered static electricity to cause the function temporary shortage, Please reinsert to pull out to recover the function.

## **Federal Communications Commission (FCC) Statement**

15.21

You are cautioned that changes or modifications not expressly approved by the part responsible for compliance could void the user's authority to operate the equipment.

15.105(b)

This equipment has been tested and found to comply with the limits for a Class B digital device, pursuant to part 15 of the FCC rules. These limits are designed to provide reasonable protection against harmful interference in a residential installation. This equipment generates, uses and can radiate radio frequency energy and, if not installed and used in accordance with the instructions, may cause harmful interference to radio communications. However, there is no guarantee that interference will not occur in a particular installation. If this equipment does cause harmful interference to radio or television reception, which can be determined by turning the equipment off and on, the user is encouraged to try to correct the interference by one or more of the following measures:

- Reorient or relocate the receiving antenna.
- Increase the separation between the equipment and receiver.
- Connect the equipment into an outlet on a circuit different from that to which the receiver is connected.
- Consult the dealer or an experienced radio/TV technician for help.

### **Operation is subject to the following two conditions:**

- 1) this device may not cause interference and
- 2) this device must accept any interference, including interference that may cause undesired operation of the device.

### **FCC RF Radiation Exposure Statement:**

This equipment complies with FCC radiation exposure limits set forth for an uncontrolled environment. End users must follow the specific operating instructions for satisfying RF exposure compliance. This transmitter must not be co-located or operating in conjunction with any other antenna or transmitter.