



Granit™ XP 1991i

Cordless Industrial Area-Imaging Scanner

Quick Start Guide

Agency Model: 1991iSR and 1991iMR+

Note: Refer to your User Guide for information about cleaning your device.

Getting Started

Turn off computer's power before connecting the scanner, then power up the computer once the scanner is fully connected. When the base is connected and powered up, put the scanner in the base to establish a link. The green LED on the base flashes to indicate the scanner's battery or charge pack is charging.

Power Supply Assembly (if included)

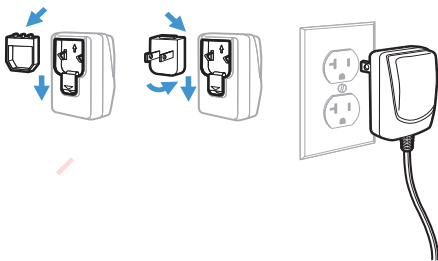

Note: The power supply must be ordered separately, if needed.

Connecting the Base

USB:

Note: *If you are charging the scanner using the USB cable, the current available for charging is reduced and charge times are increased. Charging via the power supply is faster.*

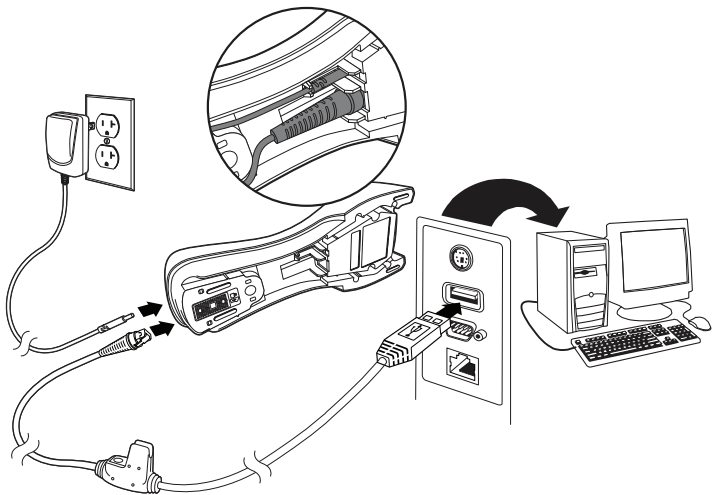

Keyboard Wedge:

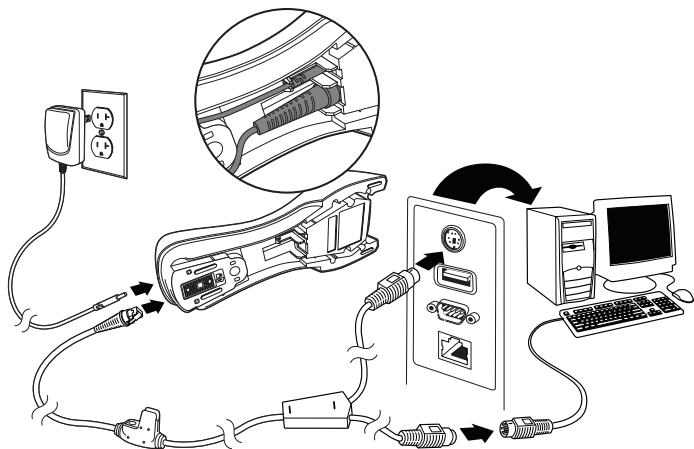

RS232 Serial Port:

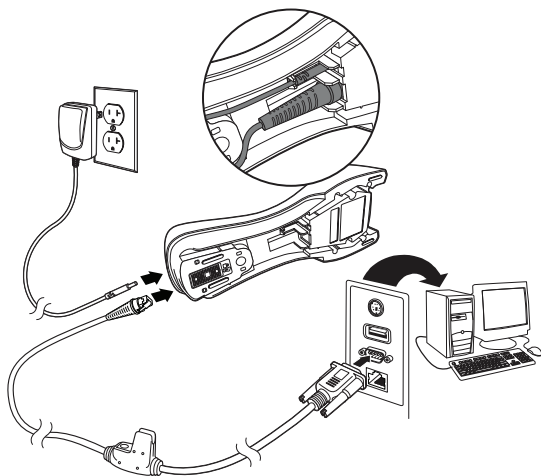

Reading Techniques

The view finder projects an aiming beam that should be centered over the bar code, but it can be positioned in any direction for a good read.

Note: *If the scanner beeps 3 times when scanning a bar code, the link has not been established. If the scanner beeps once, the link has been established.*



Standard Product Defaults

The following bar code resets all standard product default settings.



Standard Product Defaults

USB Serial



If you are using a Microsoft® Windows® PC, you must download a driver from the Honeywell website. The driver will use the next available COM Port number.

Scan the following code to program the scanner to emulate a regular RS232-based COM Port. Apple® Macintosh computers recognize the scanner as a USB CDC class device and automatically use a class driver.



USB Serial

Note: *No extra configuration (e.g., baud rate) is necessary.*

USB PC Keyboard

Scan the following code to program the scanner for a USB PC Keyboard.



USB PC Keyboard

Keyboard Country

Scan the appropriate country code below to program the keyboard layout for your country or language. By default, national character replacements are used for the following characters: # \$ @ [\] ^ ' { } ~ Refer to the ISO 646 Character Replacements chart in your User Guide to view the character replacements for each country.



USA (Default)



Belgium



Denmark



Finland



France



Germany/Austria



Great Britain



Italy



Norway



Spain



Switzerland

Note: *For a complete list of country codes, see the User Guide for your product.*

Locked Link

If you link a scanner to a base using the Locked Link Mode, other scanners are blocked from being linked if they are inadvertently placed into the base. If you do place a different scanner into the base, it will charge the scanner, but the scanner will not be linked.



Locked Link Mode
(Single Scanner)

To use a different scanner, you need to unlink the original scanner by scanning the **Unlink Scanner** bar code.

Override Locked Scanner

If you need to replace a broken or lost scanner that is linked to a base, scan the **Override Locked Scanner** bar code with a new scanner, and place that scanner in the base. The locked link will be overridden; the broken or lost scanner's link with the base will be removed, and the new scanner will be linked.



Override Locked Scanner

Unlinking the Scanner

If the base has a scanner linked to it, that scanner must be unlinked before a new scanner can be linked. Once the previous scanner is unlinked, it will no longer communicate with the base. Scan the **Unlink Scanner** bar code to unlink a scanner.



Unlink Scanner

Trigger

The following bar codes will allow you to use the scanner in **Manual Trigger - Normal Mode** (need to press the trigger to read) or **Presentation mode** (the scanner is activated when it “sees” a bar code).

Note: *Presentation Mode continuously draws power, so use of the external power supply is recommended for this mode.*



Manual Trigger - Normal
(Default)



Presentation Mode

Streaming Presentation™

When in Streaming Presentation mode, the scanner leaves the scan illumination on all the time and continuously searches for bar codes.



Streaming Presentation Mode

Suffix

If you want a carriage return after the bar code, scan the **Add CR Suffix** bar code. To add a tab after the bar code, scan the **Add Tab Suffix** bar code. Otherwise, scan the **Remove Suffix** bar code to remove the suffixes.



Add CR Suffix



Add Tab Suffix



Remove Suffix

Add Code ID Prefix to all Symbologies

Scan the following bar code if you wish to add a Code ID prefix to all symbologies at once.



Add Code ID Prefix To All Symbologies
(Temporary)

Note: For a complete list of Code IDs, see the User'Guide for your product.

Function Code Transmit

When this selection is enabled and function codes are contained within the scanned data, the scanner transmits the function code to the terminal. Charts of these function codes are provided in your User Guide. When the scanner is in keyboard wedge mode, the scan code is converted to a key code before it is transmitted.



Enable
(Default)



Disable

EZConfig for Scanning

To access additional features for the scanner, use EZConfig for Scanning, an online configuration software tool, available from our website.

Support

To search our knowledge base for a solution or to log into the Technical Support portal and report a problem, go to www.hsmcontactsupport.com.

Product Documentation

Product documentation is available at www.honeywellaidc.com.



Agency Model: 1991i

Table with 8 columns for product documentation availability in various languages: English, French, Italian, German, Spanish, Arabic, Hebrew, and Portuguese. Each column includes the language name and the website www.honeywellaidc.com.

FCC Part 15 Subpart B Class B. This device complies with part 15 of the FCC Rules. Operation is subject to the following two conditions: 1. This device may not cause harmful interference. 2. This device must accept any interference received, including interference that may cause undesired operation.

Table with 8 columns containing cautionary information and warnings in various languages, including English, French, Italian, German, Spanish, Arabic, Hebrew, and Portuguese.

Canadian Compliance. This Class B digital apparatus complies with Canadian RSS-247. Operation is subject to the following conditions: 1. This device may not cause harmful interference. 2. This device must accept any interference received, including interference that may cause undesired operation.

RF Exposure. The equipment complies with FCC RF exposure limits set forth for an uncontrolled environment. The equipment must not be co-located or operating in conjunction with any other antenna or transmitter.

IC RF Radiation Exposure. This equipment complies with IC radiation exposure limits set forth for an uncontrolled environment. Déclaration d'exposition aux radiations. Cet équipement est conforme aux limites d'exposition aux rayonnements IC établies pour un environnement non contrôlé.

Para su uso en México, la operación de este equipo está sujeta a las siguientes dos condiciones: 1. Es posible que este equipo o dispositivo no cause interferencia perjudicial. 2. Este equipo o dispositivo debe aceptar cualquier interferencia, incluyendo la que pueda causar su operación no deseada.

Table with 8 columns for TÜV R Statement and Normes TÜV R. Includes logos for TÜV Rheinland and text in English and French.

Table with 8 columns for cable usage instructions in various languages, including English, French, Italian, German, Spanish, Arabic, Hebrew, and Portuguese.

Table with 8 columns for system performance and safety warnings in various languages, including English, French, Italian, German, Spanish, Arabic, Hebrew, and Portuguese.

Table with 8 columns for patent information in various languages, including English, French, Italian, German, Spanish, Arabic, Hebrew, and Portuguese.

Table with 8 columns for product environmental information (RoHS/REACH) in various languages, including English, French, Italian, German, Spanish, Arabic, Hebrew, and Portuguese.

Table with 8 columns for product environmental information (RoHS/REACH) in various languages, including English, French, Italian, German, Spanish, Arabic, Hebrew, and Portuguese.

Table with 8 columns for product environmental information (RoHS/REACH) in various languages, including English, French, Italian, German, Spanish, Arabic, Hebrew, and Portuguese.

Table with 8 columns for Bluetooth frequency and power specifications in various languages, including English, French, Italian, German, Spanish, Arabic, Hebrew, and Portuguese.

Table with 8 columns for Bluetooth frequency and power specifications in various languages, including English, French, Italian, German, Spanish, Arabic, Hebrew, and Portuguese.

Table with 8 columns for safety warnings regarding battery replacement and disposal in various languages, including English, French, Italian, German, Spanish, Arabic, Hebrew, and Portuguese.

Table with 8 columns for safety warnings regarding battery replacement and disposal in various languages, including English, French, Italian, German, Spanish, Arabic, Hebrew, and Portuguese.

Table with 8 columns for safety warnings regarding battery replacement and disposal in various languages, including English, French, Italian, German, Spanish, Arabic, Hebrew, and Portuguese.

Table with 8 columns for safety warnings regarding battery replacement and disposal in various languages, including English, French, Italian, German, Spanish, Arabic, Hebrew, and Portuguese.



<p>CE Honeywell International Inc. 特此聲明，無線電設備類型「非特定 SRD」符合以下指令的規定： • 2014/53/EU 無線電設備 (新版) 关于欧盟符合性声明的全文，请访问以下网址： www.honeywellaidc.com/compliance 欧洲联系信息： Honeywell Productivity Solutions BV Lagelandseweg 70 6545CG Nijmegen The Netherlands</p>	<p>CE Honeywell International Inc. 特此聲明，無線電設備類型「非特定 SRD」符合下列指令的規範： • 2014/53/EU 無線電設備 (重訂) 如需歐盟符合性聲明的全文，請造訪下列網址： www.honeywellaidc.com/compliance 歐洲聯絡資訊： Honeywell Productivity Solutions BV Lagelandseweg 70 6545CG Nijmegen The Netherlands</p>	<p>CE Honeywell International Inc. は、無線電波タイプ、非特定 SRD が、以下の指令に準拠することをここに宣言します。 • 2014/53/EU 無線電機器 • 2011/65/EU RoHS (改正) EU 適合宣言書の全文は、www.honeywellaidc.com/compliance で利用可能です。 欧州でのお問い合わせ： Honeywell Productivity Solutions BV Lagelandseweg 70 6545CG Nijmegen The Netherlands</p>	<p>CE Honeywell International Inc. 는 무선 장비 유형, 일반 SRD 가 다음 지침을 준수함을 선언합니다. • 2014/53/EU 무선 장비 (Recast) EU 준수 선언문의 전문은 인터넷 주소 www.honeywellaidc.com/compliance 에서 참조할 수 있습니다. 유럽 연락처： Honeywell Productivity Solutions BV Lagelandseweg 70 6545CG Nijmegen The Netherlands</p>	<p>CE Настоящая компания Honeywell International Inc. заявляет, что радиосистемы ближнего действия соответствуют следующим директивам: • Директива 2014/53/EC по радиооборудованию • 2011/65/EU Директива RoHS (исправленная) Полный текст декларации соответствия стандартам ЕС доступен на странице www.honeywellaidc.com/compliance. Контактное лицо в Европе: Honeywell Productivity Solutions BV Lagelandseweg 70 6545CG Nijmegen The Netherlands</p>	<p>CE Honeywell International Inc. işbu belge ile radyo ekipman türlerinin belirsiz SRD'nin ve hücrelerin, aşağıdaki direktiflerde uyumlu olduğunu beyan eder: • 2014/53/EU Telsiz Ekipmanı • 2011/65/EU RoHS (Yeni düzenleme) AB uygunluk beyanının tam metnine şu internet adresinden ulaşabilirsiniz: www.honeywellaidc.com/compliance. Avrupa için iletişim: Honeywell Productivity Solutions BV Lagelandseweg 70 6545CG Nijmegen Hollanda</p>	<p>CE Honeywell شركة ان نوعية International Inc جهاز الإرسال اللاسلكي SRD المصنف كونه جهازاً لا توجيهياً مع التوجهات التالية: • جهاز الإرسال اللاسلكي وفقاً للوائح الاتحاد الأوروبي 2014/53 • توجيهات الاتحاد الأوروبي RoHS (المعاد صياغتها) 2011/65 يمكن الاطلاع على النص الكامل لإعلان المطابقة وفقاً للوائح الاتحاد الأوروبي بزيارة الموقع التالي: /www.honeywellaidc.com/compliance جهات الاتصال الأوروبية: Honeywell Productivity Solutions BV Lagelandseweg 70 6545CG Nijmegen هولندا</p>	<p>CE Honeywell International Inc מצהירה בזאת כי סוג ציוד הרדיו, SRD לא ספציפי, עומד בהתחית הבאות: • ציוד רדיו 2014/53/EU • EU RoHS/2011/65 (בערך מחדש) הטקסט המלא של הודעת ההתאמה של האיחוד האירופי זמין בכתובת האינטרנט הבאה: /www.honeywellaidc.com/compliance ליצירת קשר באירופה: Honeywell Productivity Solutions BV Lagelandseweg 70 6545CG Nijmegen The Netherlands</p>
---	---	--	---	---	---	---	--

<p>K If the following label is attached to your product, the product meets Korean agency approval: 이 기기는 가정용(B급) 전자파적합기기로서 주로 가정에서 사용하는 것을 목적으로 하며, 모든 지역에서 사용할 수 있습니다. This product is EMC B grade equipment, intended for residential use. This equipment can be used in any area.</p>	<p>CE 依據標準：低功率射頻電機技術規範：LP0002 NCC standard: Low power frequency electric machineries technical standard: LP0002 根據低功率管理辦法規定： 第十二條 經型式認證合格之低功率射頻電機，非經許可，公司、商號或使用者均不得擅自變更頻率、加大功率或變更原設計之特性及功能。 第十四條 低功率射頻電機之使用不得影響飛航安全及干擾合法通信；經發現有干擾現象時，應立即停用，並改善至無干擾時方得繼續使用。 前項合法通信，指依電信規定作業之無線電通信。低功率射頻電機須忍受合法通信或工業、科學及醫療用電波輻射性電機設備之干擾。 台灣 RoHS 網頁限用物質含有情況資訊，請依下列步驟操作： 1. 網頁連結：https://www.honeywellaidc.com/Taiwan-RoHS 2. 限用物質含有情況資訊表格是以產品型號命名的，找到對應產品型號為首的超連結，單擊即可以打開。</p>	<p>ANATEL Informações sobre Regulamentação Este produto está homologado pela ANATEL, de acordo com os procedimentos regulamentados pela Resolução nº. 242/2000 e atende aos requisitos técnicos aplicados. Este equipamento não tem direito à proteção contra interferência prejudicial e não pode causar interferência em sistemas devidamente autorizados. Para maiores informações, consulte o site da ANATEL - www.anatel.gov.br.</p>	<p>กสทช. เครื่องวิทยุคมนาคมนี้ ได้รับความเห็นชอบไม่ต้องได้รับใบอนุญาตวิทยุใช้เครื่องวิทยุคมนาคม หรือตั้งสถานีวิทยุคมนาคมตามประกาศ กสทช. และสถานีวิทยุคมนาคมที่เตรียมไว้ไม่ต้องได้รับใบอนุญาตวิทยุคมนาคม ตามพระราชบัญญัติวิทยุคมนาคม พ.ศ. 2498. เครื่องโทรคมนาคมและอุปกรณ์นี้ มีความสอดคล้องตามมาตรฐานหรือข้อกำหนดทางเทคนิคของ กสทช โทรคมนาคม กำกับดูแลเพื่อประชาชน Call Center 1200 (โทรฟรี)</p>
---	---	--	---

<p>VCCI この装置は、クラス B 機器です。この装置は、住宅環境で使用することを目的としていますが、この装置がラジオやテレビジョン受信機に近接して使用されると、受信障害を引き起こすことがあります。取扱説明書に従って正しい取り扱いをして下さい。VCCI-B</p>	
---	--

型号 (Model) : 1991i
产品中有害物质的名称及含量 (Names and Content of Hazardous Substances in the Product)

部件名称 (Parts Name)	有害物质 (Hazardous Substances)					
	铅 (Pb)	汞 (Hg)	镉 (Cd)	六价铬 (Cr6+)	多溴联苯 (PBB)	多溴二苯醚 (PBDE)
成像式二维条码阅读器 (2D Imager)	x	o	o	o	o	o
印刷电路板 (PCB)	x	o	o	o	o	o
外壳 (Housing)	x	o	o	o	o	o
连线 (Cables)	o	o	o	o	o	o
电池 (Battery)	o	o	o	o	o	o

本表格依据 SJ/T11364 的规定编制。(The table is created by SJ/T11364 requirement.)
 o: 表示该有害物质在该部件所有均质材料中的含量均在 GB/T26572 标准规定的限量要求以下。(Indicates that this hazardous substance contained in all of the homogeneous materials for this part is below the limit requirement in China's GB/T26572.)
 x: 表示该有害物质至少在该部件的某一均质材料中的含量超出 GB/T26572 标准规定的限量要求。(Indicates that this hazardous substance contained in at least one of the homogeneous materials for this part is above the limit requirement in China's GB/T26572.)

Limited Warranty

For warranty information, go to www.honeywellaidc.com and click **Resources > Product Warranty**.

Patents

For patent information, see www.hsmpats.com.

Disclaimer

Honeywell International Inc. (“HII”) reserves the right to make changes in specifications and other information contained in this document without prior notice, and the reader should in all cases consult HII to determine whether any such changes have been made. The information in this publication does not represent a commitment on the part of HII.

HII shall not be liable for technical or editorial errors or omissions contained herein; nor for incidental or consequential damages resulting from the furnishing, performance, or use of this material. HII disclaims all responsibility for the selection and use of software and/or hardware to achieve intended results.

This document contains proprietary information that is protected by copyright. All rights are reserved. No part of this document may be photocopied, reproduced, or translated into another language without the prior written consent of HII.

Copyright © 2019 Honeywell International Inc. All rights reserved.