

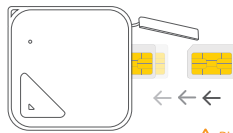

Micro SIM Card Instruction



⚠ Please pay attention to Micro SIM card direction.

- Please write down the phone number of the SIM card before putting it in the device.
- The Circo device does not support a SIM card adapter; it must use a Micro SIM card.
- The device will not turn on without a SIM card.
- Do not take out or put in the SIM card while Circo is on.
- Make sure the SIM card PIN code is unlocked. If needed, put the SIM card into a cell phone in order to unlock the PIN code.
 - Android - please insert the SIM card in an Android device, go to "Settings" --> "Security" to unlock
 - iOS - please insert the SIM card in an iOS device, go to "Settings" --> "Phone" --> "SIM PIN" to unlock
- The SIM card requires data and SMS services.
- If the SIM card works in your country, it will work while roaming abroad. Extra charges may occur when using the device roaming abroad.

Charging Instruction

1

Plug in the USB charging cable. Charging the device when it is off, first it will light up green for turning on and then turn to orange light for charging.

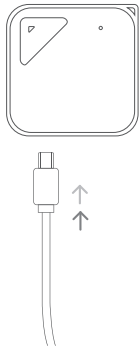

2

It requires around 2 hours for the device to be fully charged. When the device is fully charged, it will light up green.

Specifications

Model	AT502
Size	40 x 40 x 13 mm
Weight	20 +/-1 g
Battery	Rechargeable 400mAh Lithium-Ion Battery
Charger	Micro USB Cable
Sensor	G-Sensor
Cellular	GSM 850/ 900/ 1800/ 1900
Location Technologies	GPS 、 AGPS 、 WiFi 、 Cell ID
SIM card	Micro SIM
Operation Temperature	-10℃ ~ 50℃

⚠ This device is not waterproof.



Circo App Instruction

2 Create A New Account

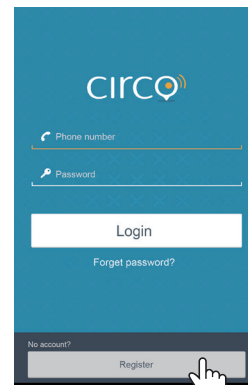

First time users are required to create an account with a phone number.

5 Enter The Phone Number Of The Device

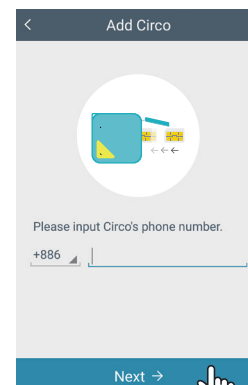

Please enter the phone number for the SIM card inside the device.

3 Pairing Your Account With A Device

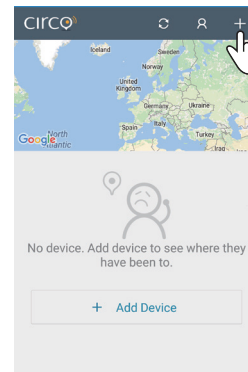

Please write down the phone number of the SIM card before putting it in the device. Then insert the SIM card and charge the device until the light turns green. You can start using the device by choosing "+" to add a device.

6 Lightly Press The Power Button

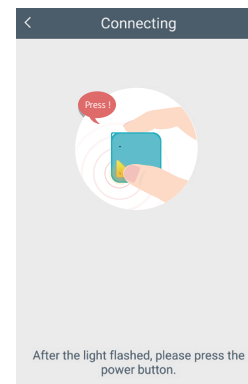

After the device light flashes orange, lightly press the power button for one second.

Names and Functions of Parts

SOS Button / Power Button
(Activates Emergency Help Feature / Turn Device On)

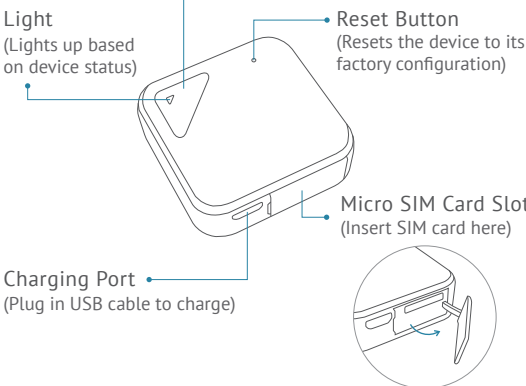

LED Light Status

The light of the device flashes only when you press the power button. If it does not light up then it is out of battery. (Already turned off)

Action	— Solid • Flash Once • • • • Flash For 8 Seconds		
	Light	Current Condition	
Press once	•	Normal condition	
	• • • •	No cellular reception	
Charging	—	Battery fully charged	
	—	Charging	
Turning On	—	Light is on until device is turned on	
	• • • •	Light flashes after turning device on means the hardware is updating	
	• • • •	No reception when turning on	

1 Download Circo App



Please search for Circo Athentek on Google Play or the Apple App Store.
Or scan the QR code above to download the Circo app.

⚠ iOS 7.0 and above or Android 4.1 and above

4 Scan QR Code Or Enter Device Number

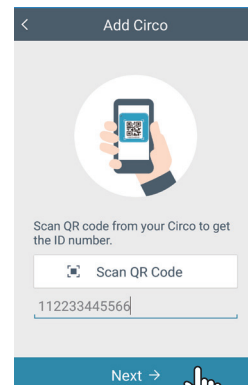

You can scan the QR code on the back of the device or manually enter the ID number.

7 Enter Device Name And Change Photo

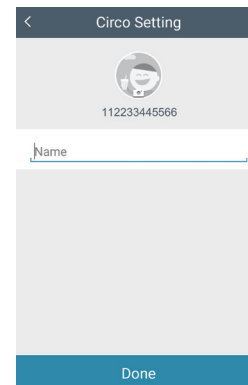

Create a name for the device and press on the camera to change the photo.
(Only the Host can change the picture of the device.)

8 Main Page

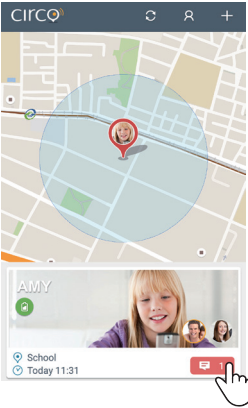

On the main page,choose a device to enter the chatroom.

9 Feature List

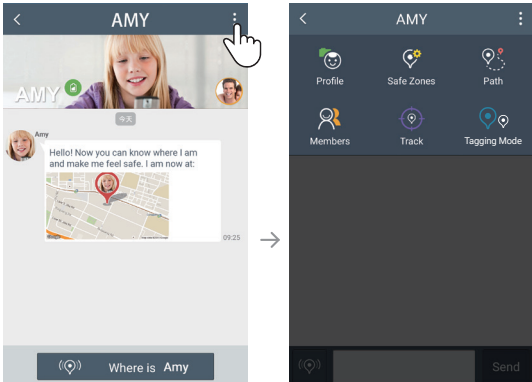

In the chatroom, press the location pin on the lower left to see the device's current location. The icon on the upper right shows more features.

10 Create Safe Zones

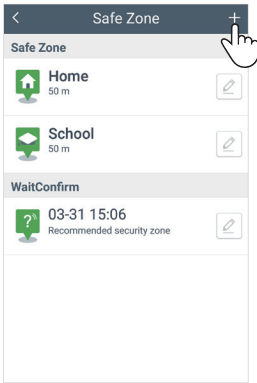

The Cloud will automatically learn places where the device visits frequently and suggest them as safe zones; you can also set them manually. You will receive notifications when the device enters or leaves a safe zone.

11 View Path History

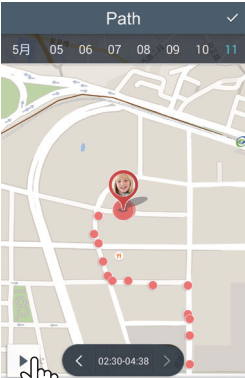

Path shows where the device has been to in the past week. You can choose a date and press play to see its path from the beginning of the day.

12 Tracking Mode

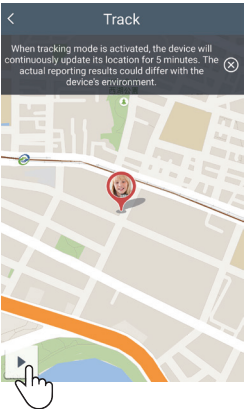

During an emergency, you can press the play button to start tracking. During tracking mode, the device will continue to update its location every 30 seconds for 5 minutes.

13 Followers Pairing With The Device

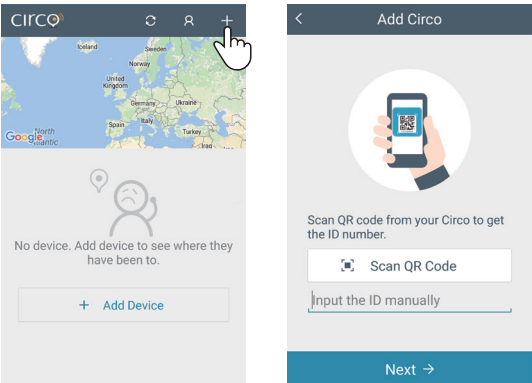

If other members want to follow this device they will also have to create an account and follow steps 3-5. (The first person to pair with the device is the Host and everyone else is Follower)

14 Wait For The Host To Confirm / The Host Will Receive Follow Request

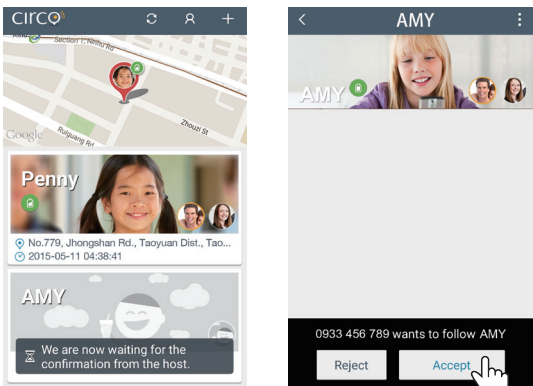

The Follower will have to wait for the Host to accept follow request. After accepting the request, followers will be able to see the device's location.

15 Group Chatroom

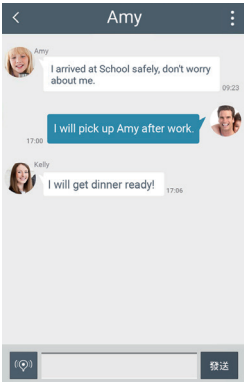

People who follow the same device can exchange messages in this chatroom.

16 Delete Followers

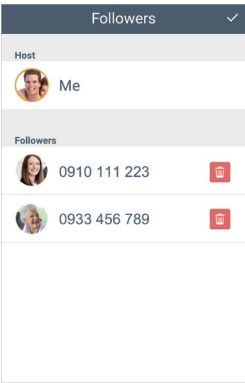

The Host can go to “Members” and delete followers. There can be up to 5 followers.

17 Emergency Help

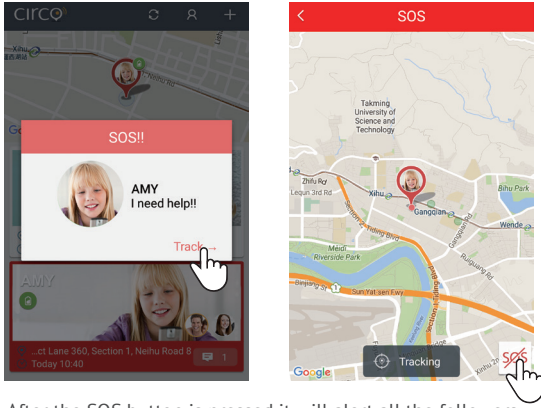

After the SOS button is pressed it will alert all the followers and update its location continuously. You can turn off SOS on the tracking page.

Circo Status Guide

Status icons on the app

	Turned off
	10 % battery left / Charging
	30 % battery left / Charging
	75% battery left / Charging
	Fully charged with 100% battery
	The device is offline
	Sleep mode
	Firmware updating
	Inside safe zone
	Outside safe zone

Questions

- How do I turn Circo on?**
Gently press and briefly hold down the power button until the Circo light turns red.
- Why does Circo not turn on?**
The battery might be low. Please plug in the micro USB cable to charge Circo. Please make sure Circo has a working SIM card.
- Why does the Circo app say the device is not available or pairing fails?**
 - If you enter an incorrect SIM card mobile phone number, please wait for 10 minutes to retry.
 - If you forgot to press the power button when Circo lit up, please re-enter the device ID and add the device again.
 - If your location has poor cellular reception, then Circo may not be able to pair up with the Circo app.
- What are Standby, Safe Zone, and Outdoor usage scenarios?**
When Circo is on **Standby**, it can last 5-6 days; Circo is inside a safe zone without movement. Under **Safe Zone** scenario Circo can last 3-5 days, meaning the user commutes for 2 hours and stays inside a safe zone rest of the time. When Circo is **Outdoor** and moving from place to place, it can last 1-3 days. All these scenarios include 8 hours of sleep time and have Safe Zones set for places like work, school, and home.

Contact Us

If you have any questions or suggestions, please contact us at any time.

AthenTek



<http://www.athentek.com>



sales@athentek.com

Note

Federal Communications Commission (FCC) Statement
15.19
This device complies with Part 15 of the FCC Rules.
Operation is subject to the following two conditions:
1) this device may not cause harmful interference and
2) the device must accept any interference received, including interference that may cause undesired operation of the device.

15.21
You are cautioned that changes or modifications not expressly approved by the part responsible for compliance could void the user's authority to operate the equipment.

15.105(b)
This equipment has been tested and found to comply with the limits for a Class B digital device, pursuant to part 15 of the FCC rules. These limits are designed to provide reasonable protection against harmful interference in a residential installation. This equipment generates, uses and can radiate radio frequency energy and, if not installed and used in accordance with the instructions, may cause harmful interference to radio communications. However, there is no guarantee that interference will not occur in a particular installation. If this equipment does cause harmful interference to radio or television reception, which can be determined by turning the equipment off and on, the user is encouraged to try to correct the interference by one or more of the following measures:
-Reorient or relocate the receiving antenna.
-Increase the separation between the equipment and receiver.
-Connect the equipment into an outlet on a circuit different from that to which the receiver is connected.
-Consult the dealer or an experienced radio/TV technician for help.

For body worn operation, this device has been tested and meets FCC RF exposure guidelines when used with an accessory that contains no metal and that positions the handset a minimum of 5 mm from the body. Use of other accessories may not ensure compliance with FCC RF exposure guidelines. The highest FCC SAR values:
• 1.467 W/Kg (1g) (Body)

CE marking
This equipment complies with the requirements of Directive 1999/5/EC of the European Parliament and Commission from 9 March, 1999 governing Radio and Telecommunications Equipment and mutual recognition of conformity.
The device complies with the following harmonized European
EN 301489-1 V1.9.2 / EN 301489-3 V1.6.1 / EN 301489-7 V1.3.1 / EN 301489-17 V2.2.1
EN 300328 V1.9.1 / EN 300440-1 V1.6.1 / EN 300440-2 V1.4.1 / EN 301511 V9.0.2
EN 50566: 2013 / EN 62209-2:2010 / EN 62479: 2010
EN 60950-1: 2006+A11: 2009+A12:2010+A12:2011+A2:2013

The highest
CE SAR values for the device are as follows:
0.904 W/Kg (10g) (Body)

CE RF Exposure Compliance
This device meets the EU requirements (1999/519/EC) on the limitation of exposure of the general public to electromagnetic fields by way of health protection. For body-worn operation, this device has been tested and meets the ICNIRP guidelines and the European Standard EN 62209-2, for use with dedicated accessories. SAR is measured with this device at a separation of 5 mm to the body, while transmitting at the highest certified output power level in all frequency bands of this device. Use of other accessories which contain metals may not ensure compliance with ICNIRP exposure guidelines.

CE 0560

FCC ID : 2AHNY-AT502