

## RGBW Remote Control User Instruction

Thanks for your purchase !

Welcome to the Smart LED Lighting System. This manual describes the simple bulb which can work with the RGBW remote control .Please read the instruction manual carefully before using. Quick and Easy installation of the Smart LED Bulb is the same as any other common light bulb. The bulb must be screwed into the light socket and switched on at the wall for 2.4Ghz wireless operation, allowing the remote control to turn the LED bulb on/off, dim/brighten and color change. Secure communication is done by linking the remote and bulb once.

This manual describes the RGB white remote control used for RGBW light bulb. It can control the led lights up to four different zones, change the color, dim/brighten the lights, warm white , different programs. In this manual, you will learn about:

- > **Basic functions of the remote control:**
- > **Linking new lights to the remote control:**
- > **Grouping multiple lights:**

### Basic control functions

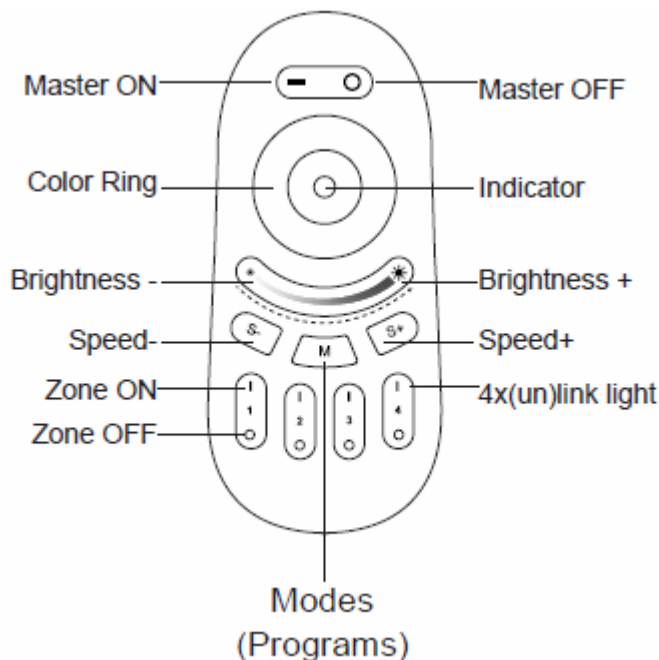

Long press 'Master ON'/'Zone ON' button, you can get the white mode. Touch the color ring, you can get any color. And you can change the brightness by the brightness ring + -.

### Programs:

#### Program 1 ( RGBW Fade In Fade Out)

This program fades in and fades out the color red, green, blue and white one after another.

**Program2( Color Flash)**

In this program, red, green, blue, white yellow purple flashes to change.

**Program 3 ( Disco)**

Different colors strobe and flash to change.

**Program 4 (Red Color Ramp up and Flash)**

In this program, red color brightens from 0%-100% and shuts down, then flashes three times.

**Program 5 (Green Color Ramp up and Flash)**

In this program, green color brightens from 0%-100% and shuts down, then flashes three times.

**Program 6 (Blue Color Ramp up and Flash)**

In this program, blue color brightens from 0%-100% and shuts down, then flashes three times.

**Program 7( Color Change+ Flash)**

Here several colors fade into each other and then flash randomly.

**Program 8 ( Fade in and Fade out)**

Here different colors fade into each other.

**Program 9 (Strobe White)**

Just white color flashes up.

**TIPS:**

. To dim all RGBW lights at once or change the color, first press ' Master ON'. To do this with individual lights, first press 'Zone ON'. Secondly, choose the color or brightness according to the color ring or brightness ring.

**Linking new lights to the remote controls:**

1. Choose which zone you want to assign the light( 1 to 4)
2. Switch off the 220V main power supply of the light in the selected zone with the main switch or pull the plug from the socket.
3. Now switch on the light again and within 3 seconds shortly press one of the 'Zone ON' buttons one time on the remote control.
4. When this link operation is successful, the light slowly blinks 3 times on and off.

**Unlinking the white lights:**

1. Check via the remote control to see which zone ( 1 to 4) is already linked to a light.
2. Switch off the 220V main power supply of the light with the main switch or pull the plug from the socket.

3. Now switch on the light again and within 3 seconds press 5 times quickly and shortly on one of the 'Zone ON' buttons which you wan to link.
4. When this unlink operation is successful, the light quickly blinks 10 times on and off.

### Grouping of several dual white lights

You can add an endless numbers of lights to a zone on the 4 channel remote by linking the lights to different zones. This way you are completely flexible in creating different group combinations. Below you can see some grouping examples.

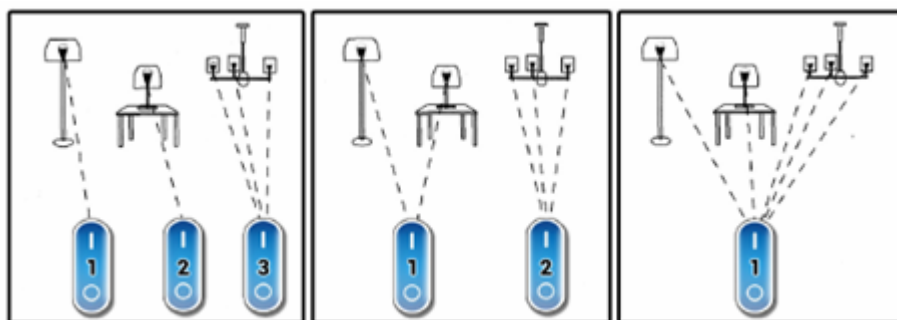

We recommend using rechargeable batteries for the remote controls.

For that reason, we don't include ordinary batteries. We hope you appreciate our environmental friendly choices and they do not cause you any inconvenience.

FCC Caution: Any changes or modifications not expressly approved by the party responsible for compliance could void the user's authority to operate this equipment.

This device complies with Part 15 of the FCC Rules. Operation is subject to the following two conditions: (1) This device may not cause harmful interference, and (2) this device must accept any interference received, including interference that may cause undesired operation. This device and its antenna(s) must not be co-located or operating in conjunction with any other antenna or transmitter.

changes or modifications not expressly approved by the party responsible for compliance could void the user's authority to operate the equipment.